

\$596,000 - 37 Elkstone Way, Rural Rocky View County

MLS® #A2239314

\$596,000

0 Bedroom, 0.00 Bathroom,
Land on 2.30 Acres

Glendale Meadows, Rural Rocky View County,
Alberta

Welcome to ELKSTONE ESTATES (Lot #5), a prime opportunity in the peaceful rural enclave of Bearspaw. Discover the perfect balance of country charm and city convenience, with essential amenities just a short drive away. This newly released 2.3-acre parcel sits on a quiet cul-de-sac with paved roads, mature trees, and underground services to the property line (Power, Gas, and Rocky View Water Co-op) plus a finished paved approach. Bring your own builder and create the home youâ€™ve always envisionedâ€”flexible Architectural Guidelines are in place to maintain the integrity and value of this exceptional development. Schedule a viewing today and explore the possibilities of this remarkable lot in Bearspaw first hand! Bonus for builders: 4 lots currently available in this highly desirable Bearspaw location.

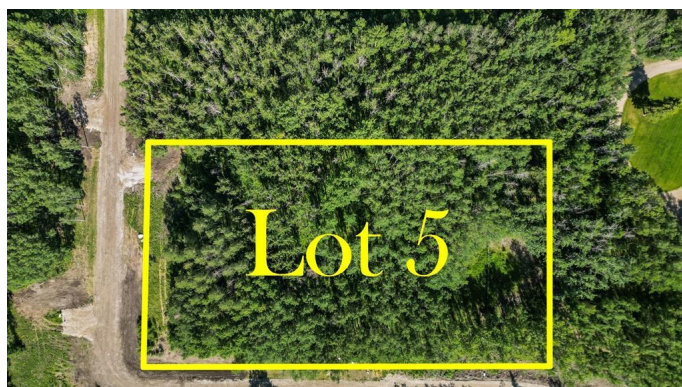

Essential Information

MLS® #	A2239314
Price	\$596,000
Bathrooms	0.00
Acres	2.30
Type	Land
Sub-Type	Residential Land
Status	Active

Community Information

Address	37 Elkstone Way
Subdivision	Glendale Meadows
City	Rural Rocky View County
County	Rocky View County
Province	Alberta
Postal Code	T4C 2Y8

Amenities

Utilities	Electricity at Lot Line, Natural Gas at Lot Line, Water At Lot Line
-----------	---

Additional Information

Date Listed	July 12th, 2025
Days on Market	5
Zoning	R-CRD

Listing Details

Listing Office	RE/MAX House of Real Estate
----------------	-----------------------------

Data is supplied by Pillar 9â„¢ MLS® System. Pillar 9â„¢ is the owner of the copyright in its MLS® System. Data is deemed reliable but is not guaranteed accurate by Pillar 9â„¢. The trademarks MLS®, Multiple Listing Service® and the associated logos are owned by The Canadian Real Estate Association (CREA) and identify the quality of services provided by real estate professionals who are members of CREA. Used under license.