

# \$30,000 - 220 Bruce Avenue, Carbon

MLS® #A2215742

**\$30,000**

0 Bedroom, 0.00 Bathroom,  
Land on 0.35 Acres

NONE, Carbon, Alberta

Direct control zoning n Carbon, the Village in the Valley. A gravelled 15080 square foot lot in a residential area, across from the Carbon School. Carbon is a growing vibrant village with approximately 500 residents, a dramatic growth in recent years. About an hour to Calgary, under 30 mins to both Three Hills and Drumheller, and just off the highway 9 and trucking routes for easy for local business, shipping, and more .

## Essential Information

MLS® #	A2215742
Price	\$30,000
Bathrooms	0.00
Acres	0.35
Type	Land
Sub-Type	Commercial Land
Status	Active

## Community Information

Address	220 Bruce Avenue
Subdivision	NONE
City	Carbon
County	Kneehill County
Province	Alberta
Postal Code	T0M0L0

## Additional Information

Date Listed	April 28th, 2025
-------------	------------------

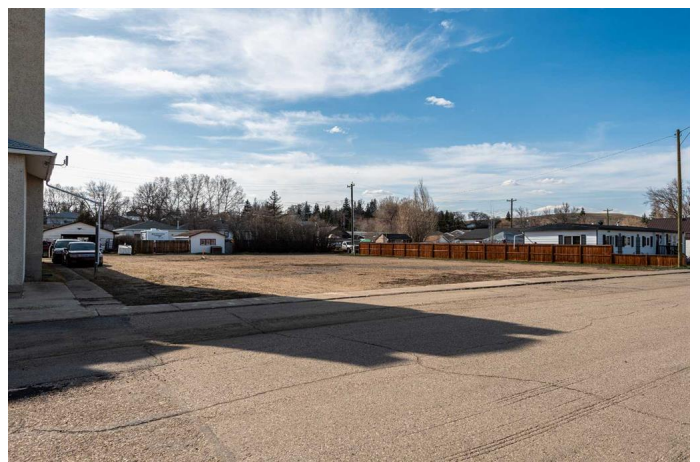

Days on Market	115
Zoning	Direct Control

## **Listing Details**

Listing Office	Royal LePage Country Realty
----------------	-----------------------------

Data is supplied by Pillar 9â„¢ MLSÂ® System. Pillar 9â„¢ is the owner of the copyright in its MLSÂ® System. Data is deemed reliable but is not guaranteed accurate by Pillar 9â„¢. The trademarks MLSÂ®, Multiple Listing ServiceÂ® and the associated logos are owned by The Canadian Real Estate Association (CREA) and identify the quality of services provided by real estate professionals who are members of CREA. Used under license.